

MASTER PLAN

Landscape Legend

- | | |
|--|----------------------------------|
| 1. Entry | 31. Spill Over Plaza For Banquet |
| 2. Exit | 32. Central Lawn |
| 3. Entry/exit | 33. Parterre Garden |
| 4. Entry Water Feature | 34. Landscape Corridor |
| 5. Boundary Wall | 35. Raised Pavilion |
| 6. Guard Room | 36. Amphitheater |
| 7. Drive Way | 37. Jogging Track |
| 8. Main Drop Off I | 38. Pool Lawn |
| 9. Main Drop Off II | 39. Swimming Pool |
| 10. Landscape Island At Drop Off | 40. Kids Pool |
| 11. Feature Wall | 41. Pool Loungers |
| 12. Water Body | 42. Pool Deck |
| 13. Terminalia Courts | 43. Outdoor Kitchen/buffet |
| 14. Landscape Pocket Gardens In Front | 44. Facility Block |
| 15. Feature Pavilion | 45. Surprise Fountain |
| 16. Lily Pond | 46. Kids Play Area |
| 17. Monds | 47. Banquet Lawn |
| 18. Landscape Courts At Stilt Area | 48. Celebration Deck |
| 19. Commercial Entry Plaza | 49. Lawn Tennis Court |
| 20. Drop Off At Banquet | 50. Cricket Pitch |
| 21. Landscape Island At Banquet Drop Off | 51. Basketball Court |
| 22. Screen Planting | 52. Yoga And Meditation |
| 23. Entry Plaza For Banquet | 53. Open Gym |
| 24. Ramp To/from Basement | 54. Aromatic Garden |
| 25. Parking | 55. Butterfly Garden |
| 26. Connecting Pathway | 56. Pet Park |
| 27. Lounge Area Water Feature | 57. Peripheral Buffer Green |
| 28. Landscape Court Under Staircase | 58. School / Ews |
| 29. Landscape Plaza | 59. Commercial |
| 30. Landscape Edges Along Building | |

Note: All information, images and visuals, drawings, plans of sketches shown in this brochure are only an architects impression, representative images or artistic renderings and not to scale. Nothing contained herein intends to constitute a legal offer and does not form part of any legally binding agreement and/or commitment of any nature. Recipients/viewers are advised to exercise their discretion in relying on the information shown/provided and are requested to verify all the details, including area, amenities, services, terms of sales and payments and other relevant terms independently with the Sales Team/Company, gather thorough understanding of the same and take appropriate advice prior to concluding any decision for buying any Unit(s) in the Project. Some floor plans will be mirror images of above indicative typical floor plans

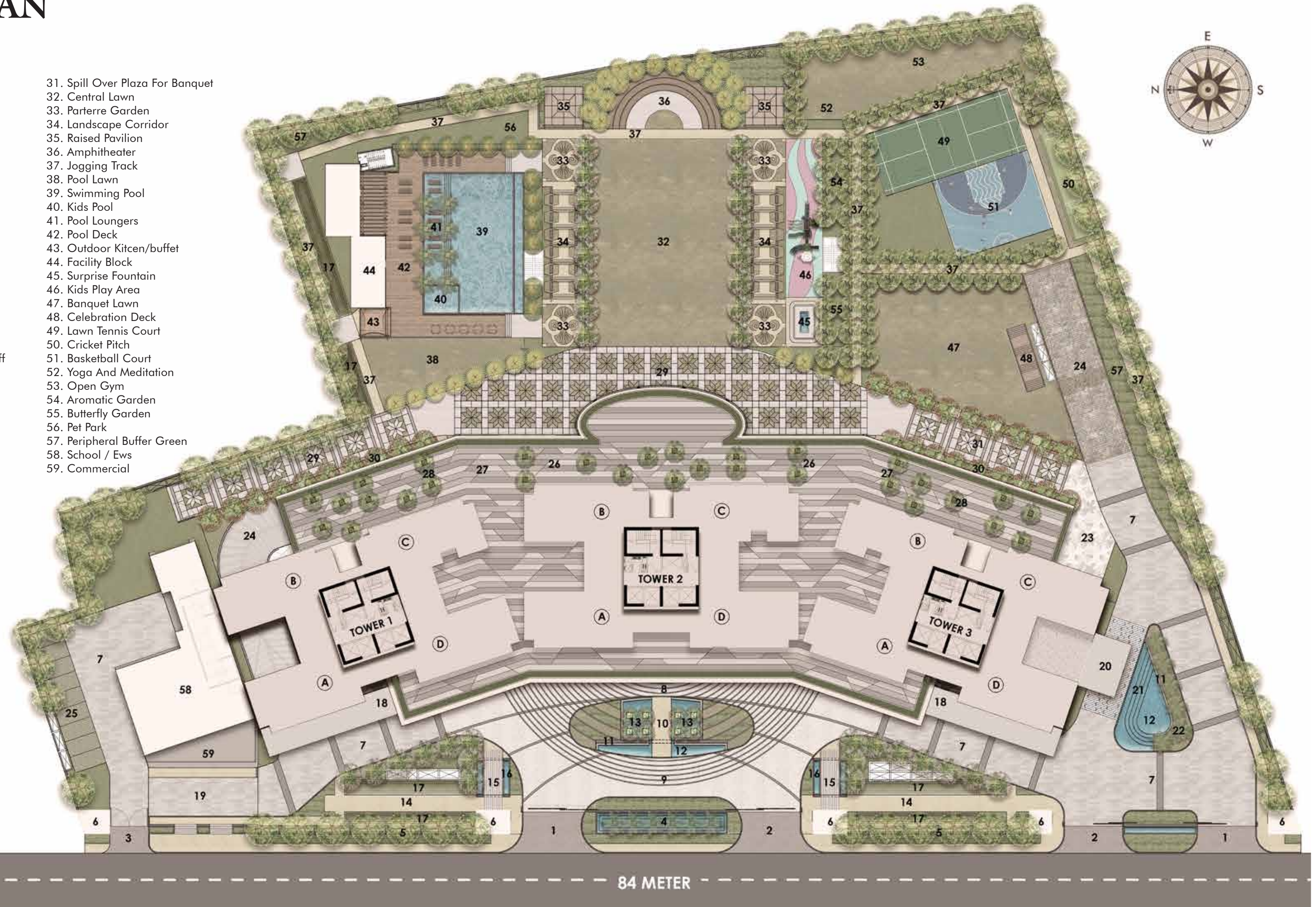

84 METER